

Title Number : K896435

This title is dealt with by HM Land Registry, Nottingham Office.

The following extract contains information taken from the register of the above title number. A full copy of the register accompanies this document and you should read that in order to be sure that these brief details are complete.

Neither this extract nor the full copy is an 'Official Copy' of the register. An official copy of the register is admissible in evidence in a court to the same extent as the original. A person is entitled to be indemnified by the registrar if he or she suffers loss by reason of a mistake in an official copy.

This extract shows information current on 1 SEP 2020 at 14:13:58 and so does not take account of any application made after that time even if pending in HM Land Registry when this extract was issued.

REGISTER EXTRACT

Title Number	: K896435
Address of Property	: land on the north side of Station Road, Hythe
Price Stated	: £120,000
Registered Owner(s)	: ST AUGUSTINES HYTHE LIMITED (Co. Regn. No. 9658336) of Third Floor, 24 Chiswell Street, London EC1Y 4YX.
Lender(s)	: None

Title number K896435

This is a copy of the register of the title number set out immediately below, showing the entries in the register on 1 SEP 2020 at 14:13:58. This copy does not take account of any application made after that time even if still pending in HM Land Registry when this copy was issued.

This copy is not an 'Official Copy' of the register. An official copy of the register is admissible in evidence in a court to the same extent as the original. A person is entitled to be indemnified by the registrar if he or she suffers loss by reason of a mistake in an official copy. If you want to obtain an official copy, the HM Land Registry web site explains how to do this.

A: Property Register

This register describes the land and estate comprised in the title.

KENT : FOLKESTONE AND HYTHE

- 1 (30.01.2006) The Freehold land shown edged with red on the plan of the above title filed at the Registry and being land on the north side of Station Road, Hythe.

B: Proprietorship Register

This register specifies the class of title and identifies the owner. It contains any entries that affect the right of disposal.

Title absolute

- 1 (07.12.2016) PROPRIETOR: ST AUGUSTINES HYTHE LIMITED (Co. Regn. No. 9658336) of Third Floor, 24 Chiswell Street, London EC1Y 4YX.
- 2 (24.05.2010) RESTRICTION: Until 5 May 2036 no disposition of the registered estate by the proprietor of the registered estate or by the proprietor of any registered charge is to be registered without a certificate signed by the conveyancer for the time being of the Transferor that the provisions of clause 4.1 of a Deed dated 5 May 2010 made between (1)Rev. J Hine and Others (2) The Southwark Roman Catholic Diocesan Corporation and (3) Paul Kingston have been complied with.
- 3 (07.12.2016) The price stated to have been paid on 13 November 2015 was £120,000.
- 4 (07.12.2016) The Transfer to the proprietor contains a covenant to observe and perform the covenants referred to in the Charges Register and of indemnity in respect thereof.
- 5 (15.05.2017) The proprietor's address for service has been changed.

C: Charges Register

This register contains any charges and other matters that affect the land.

- 1 (30.01.2006) A Conveyance dated 9 December 1912 made between (1) The Seabrook Estate Company Limited and (2) Frank Usher contains restrictive covenants.

NOTE: Copy Abstract filed.

End of register

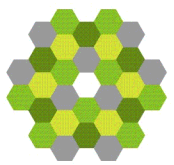

©Crown Copyright. Produced by HM Land Registry. Reproduction in whole or in part is prohibited without the prior written permission of Ordnance Survey. Licence Number 100026316

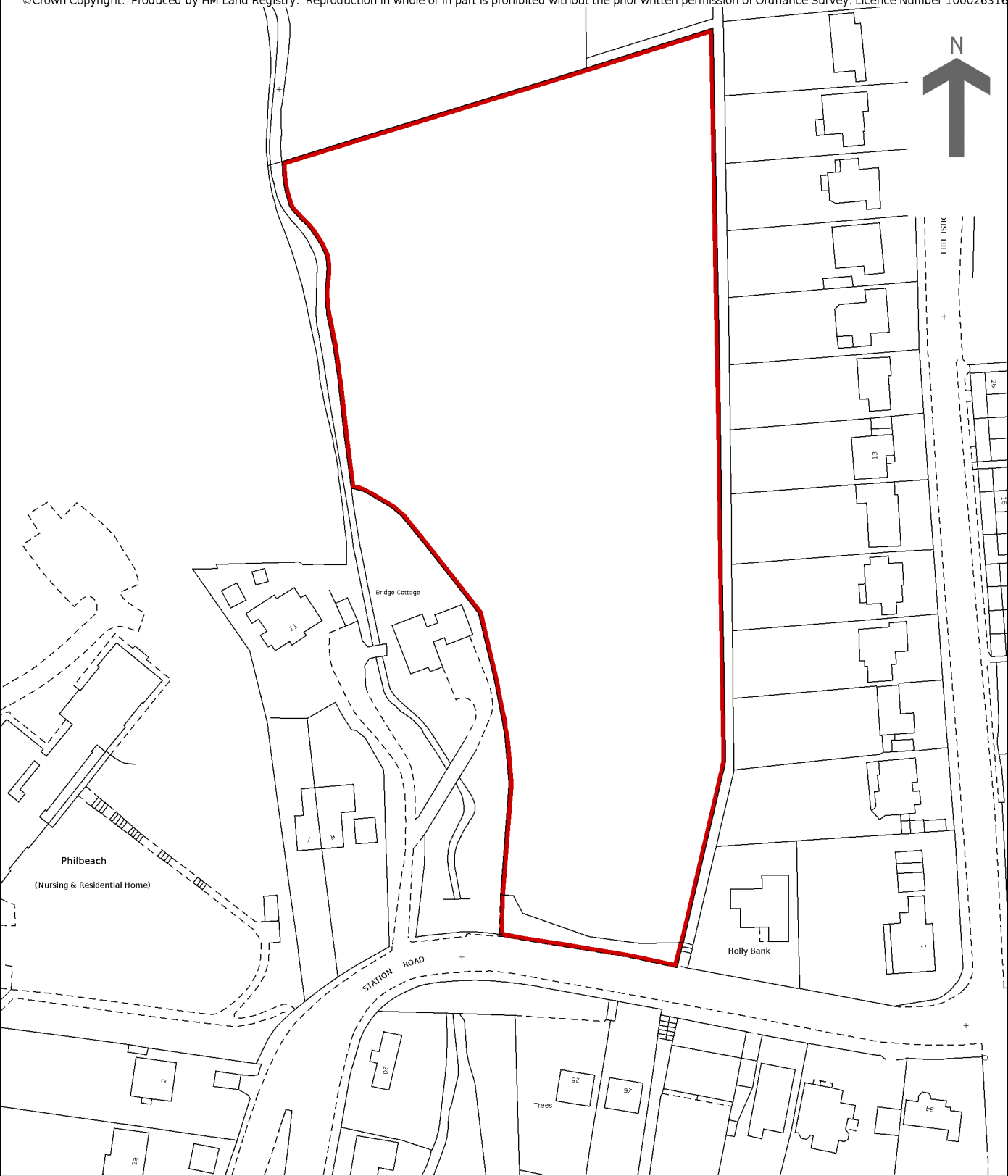

This is a copy of the title plan on 1 SEP 2020 at 14:13:58. This copy does not take account of any application made after that time even if still pending in HM Land Registry when this copy was issued.

This copy is not an 'Official Copy' of the title plan. An official copy of the title plan is admissible in evidence in a court to the same extent as the original. A person is entitled to be indemnified by the registrar if he or she suffers loss by reason of a mistake in an official copy. If you want to obtain an official copy, the HM Land Registry web site explains how to do this.

HM Land Registry endeavours to maintain high quality and scale accuracy of title plan images. The quality and accuracy of any print will depend on your printer, your computer and its print settings. This title plan shows the general position, not the exact line, of the boundaries. It may be subject to distortions in scale. Measurements scaled from this plan may not match measurements between the same points on the ground.

This title is dealt with by HM Land Registry, Nottingham Office.